

Manoeuvrable and compact

Maintenance-free AC drive motor

On-board charger

Range of coupling options



EZS 010

Pedestrian mini tow tractor (1000 kg)

The Jungheinrich EZS 010 is a versatile, economical mini tow tractor for pulling up to 1000 kg trailers. Ideal for moving loads in restrictive applications. Instead of time-consuming and heavy manual work, you can now move trailers faster, more efficiently and more easily. In a wide range of applications including furniture retail stores, inside

factories, supermarkets or hospitals. Wherever smaller loads have to be transported over short distances, the EZS 010 is the clear choice with compelling advantages:

- Range of coupling systems for various trailer types.
- Easily accessible coupling, clearly visible from the top.

- 24 volt AC drive motor.
- Ergonomic safety tiller arm.
- Compact, user-friendly design.
- Machine turns on the spot.
- Drive tyre protected by chassis.
- A choice of three travel programmes.

EZS 010

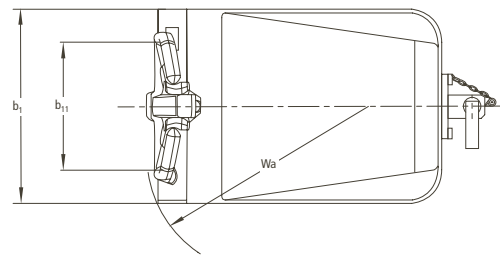
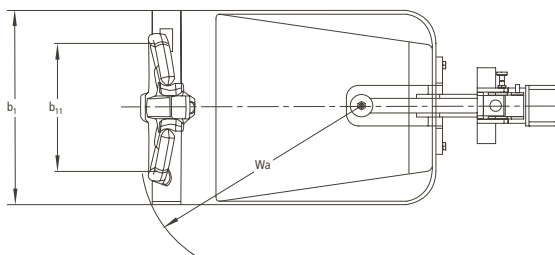
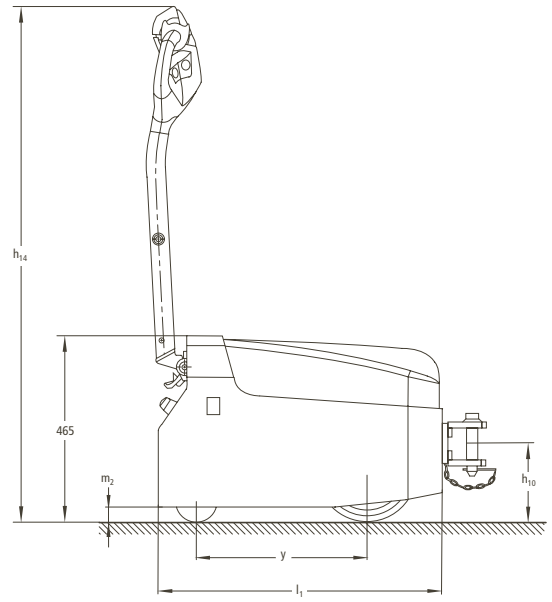
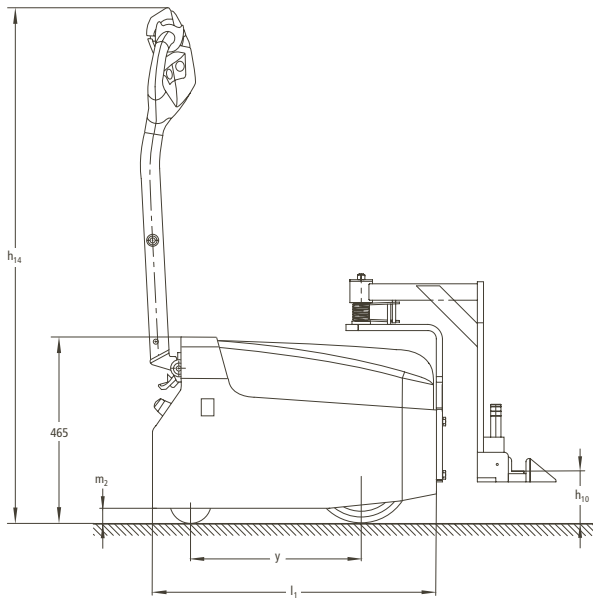

Technical data in line with VDI 2198 as at: 09/2009

Identification	1.1	Manufacturer (abbreviation)		Jungheinrich	1.1
	1.2	Manufacturer's type designation		EZS 010	1.2
	1.3	Drive		electric	1.3
	1.4	Operator type		pedestrian	1.4
	1.5	Load capacity/rated load	Q (t)	1	1.5
	1.7	Rated drawbar pull	F (N)	200	1.7
	1.9	Wheelbase	y (mm)	415	1.9
Weights	2.1	Service weight	kg	190	2.1
	2.3	Axle loading, unladen front/rear	kg	85/105	2.3
Wheels, Chassis	3.1	Tyres		Vulkollan®, solid rubber	3.1
	3.2	Tyre size, front	mm	100 x 40	3.2
	3.3	Tyre size, rear	mm	230 x 70	3.3
	3.5	Wheels, number front rear (x = driven wheels)		2/1x, 2	3.5
	3.6	Track width, front	b ₁₀ (mm)	315	3.6
	3.7	Track width, rear	b ₁₁ (mm)	370	3.7
	Basic Dimensions	4.9	Height of tiller in drive position min./max.	h ₁₄ (mm)	1270
4.19		Overall length	l ₁ (mm)	700	4.19
4.21		Overall width	b ₁ /b ₂ (mm)	480/-	4.21
4.32		Ground clearance, centre of wheelbase	m ₂ (mm)	35	4.32
4.35		Turning radius	Wa (mm)	570	4.35
Performance Data	5.1	Travel speed, laden/unladen	km/h	5.4/6.0	5.1
	5.5	Drawbar pull, laden/unladen	N	- / 200	5.5
	5.6	Max. drawbar pull, laden/unladen	N	- / 600	5.6
	5.10	Service brake		electromagnetic	5.10
E-Motor	6.1	Drive motor rating S ₂ 60 min	kW	1	6.1
	6.4	Battery voltage, nominal capacity K ₃	V/Ah	24/63	6.4
	6.5	Battery weight	kg	46	6.5
Others	8.1	Type of drive control		AC SpeedControl	8.1

Make use of the advantages

Innovative AC technology

Jungheinrich AC motors offer higher performance and save on running costs: Apply these benefits:

- High efficiency levels with excellent energy management.
- Powerful acceleration.
- Quick travel direction change without pause.
- No carbon brushes – maintenance-free drive motor.
- Two-year warranty on the drive motor.

Constant information flow

Extensive display and setting controls provide a complete overview at all times:

- Combined discharge indicator (3 colour LED) with load status display.
- CanDis (optional) provides information on battery charge status, service hours and error codes.
- PIN activation of truck and choice of 3 travel programmes via keypad (optional).
- Adjustable drive parameters via CanDis and CanCode (optional).



Clearly arranged controls always in view



Easy trailer shunting

Work ergonomically

The new tiller arm has been designed to match the ergonomic requirements of the operator:

- Colour coding and buttons with countersunk/raised shape for intuitive operation.
- Grip position ideally suited to the operator's hand.
- Crawl speed button underneath the tiller arm for easy access and travelling with the tiller upright.
- High protection level of electric controller to IP 65 giving high reliability.
- Rocker switches for equally good operation in any tiller position.

Minimum maintenance work

The AC drive system and small number of moving parts keeping running costs to a minimum:

- Maintenance-free AC drive motor with no carbon brushes.
- Easy access to all parts inside one-piece front panel with just 2 screws.
- Excellent protection against dust and humidity through enclosure of controller and plugs to IP 54.

Easy charging

The battery can be recharged at any socket with the on-board charger.



Individual coupling solutions to suit the trailer

Individual coupling solutions

Individual coupling solutions enable the truck to be used with a range of trailer types. Both standard couplings (e.g. single plug couplings) and modified couplings can be used.

- Standard couplings attached to the chassis if the trailer has its own steering.
- Coupling arm can be used with a modified receptacle for non-self steering trailers. This ensures easy steering and effortless direction of trailers.

Jungheinrich UK Ltd.

Head Office:

Sherbourne House · Sherbourne Drive
Tilbrook · Milton Keynes MK7 8HX
Phone 01908 363100
Fax 01908 363180

info@jungheinrich.co.uk
www.jungheinrich.co.uk



Jungheinrich
Plants, Sales and
Services Europe
ISO 9001/ISO 14001

Jungheinrich trucks
conform to the European
Safety Requirements.



JUNGHEINRICH
Well worthwhile